

BANGKOK INTERNATIONAL TRADE & EXHIBITION CENTRE

TRANSFORMING EVENTS TO ENJOYMENT SINCE 1997

YOUR **EVENT.** OUR **EXPERTISE.**

DEVELOPED AND MANAGED BY



Health & Safety Standards for the Emergence of COVID-19



Sources:

- Official announcement of update health & safety regulations and measures by the Center for COVID-19 Situation Administration (CCSA)
- Official announcement of update health & safety regulations and measures by Bangkok Metropolitan Administration (BMA), .
- Department of Disease Control, Draft Measures for MICE Industry & TEA New Norm for Exhibition and Conference, 14 May 2020
- Global framework for reopening exhibitions and B2B trade events post the emergence from COVID-19, May 2020
- Convention & Exhibition Centre Health & Safety: Managing COVID-19 Challenges, April 2020
- MICE Hygiene Guidelines, April 2020
- WHO & Unisef: Water, sanitation, hygiene and waste, management for the COVID-19 virus, Technical brief, March 2020

BITEC, We care for you
VDO

BITEC

NEW NORMAL

BITEC, We care for you Framework



1. Track & Trace

- Thai Chana check-in & check-out

2. Screen & Check

- 37.5 degree check before entry with mask
- Management of a suspected case

3. Access & Crowd Control

- Limit attendee and density 1:4 sq.m.

4. Physical Distancing

- Manage holding area with physical distancing
- Mark floor and signage at least 1 m. distance

BITEC, We care for you Framework

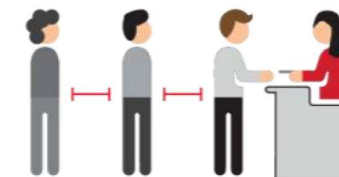
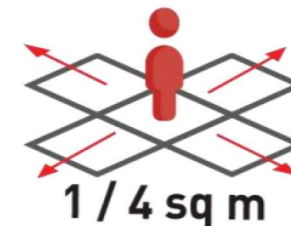

BITEC, We care for you

Framework



5. Safety & Hygiene

- Sanitizer and disinfection
- Hand sanitizer
- Extra cleaners and frequency
- Innovation of UVC Light Disinfection
- Food safety experiences
- Etc.



6. Encourage & Enforce

- Provide training and manual for staff before onsite
- Enforce the measures in place



- Scan check-in & check-out at 'Thai Chana' QR code/ Application
- Real-time monitor on the application
- Display monitors on check-in area
- Standby manual registration option
- Available for data trace and tracking

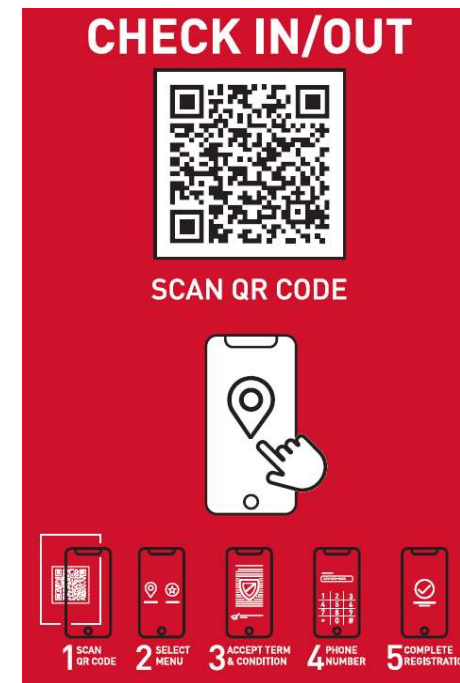

Track & Trace



ไทยชนะ



- Infrared thermal scan units and equipment for carrying out body temperature of health screening, 37.5 up degree Celsius, on main entrances
- Deny entry of attendee/visitors who refuse to wear mask and/ or prevention materials



Screen & Check



- Management of a suspected case
- Surveillance rooms with control measures and intensive health protection procedure, in case of people at risk found.



Management of a suspected case of COVID-19

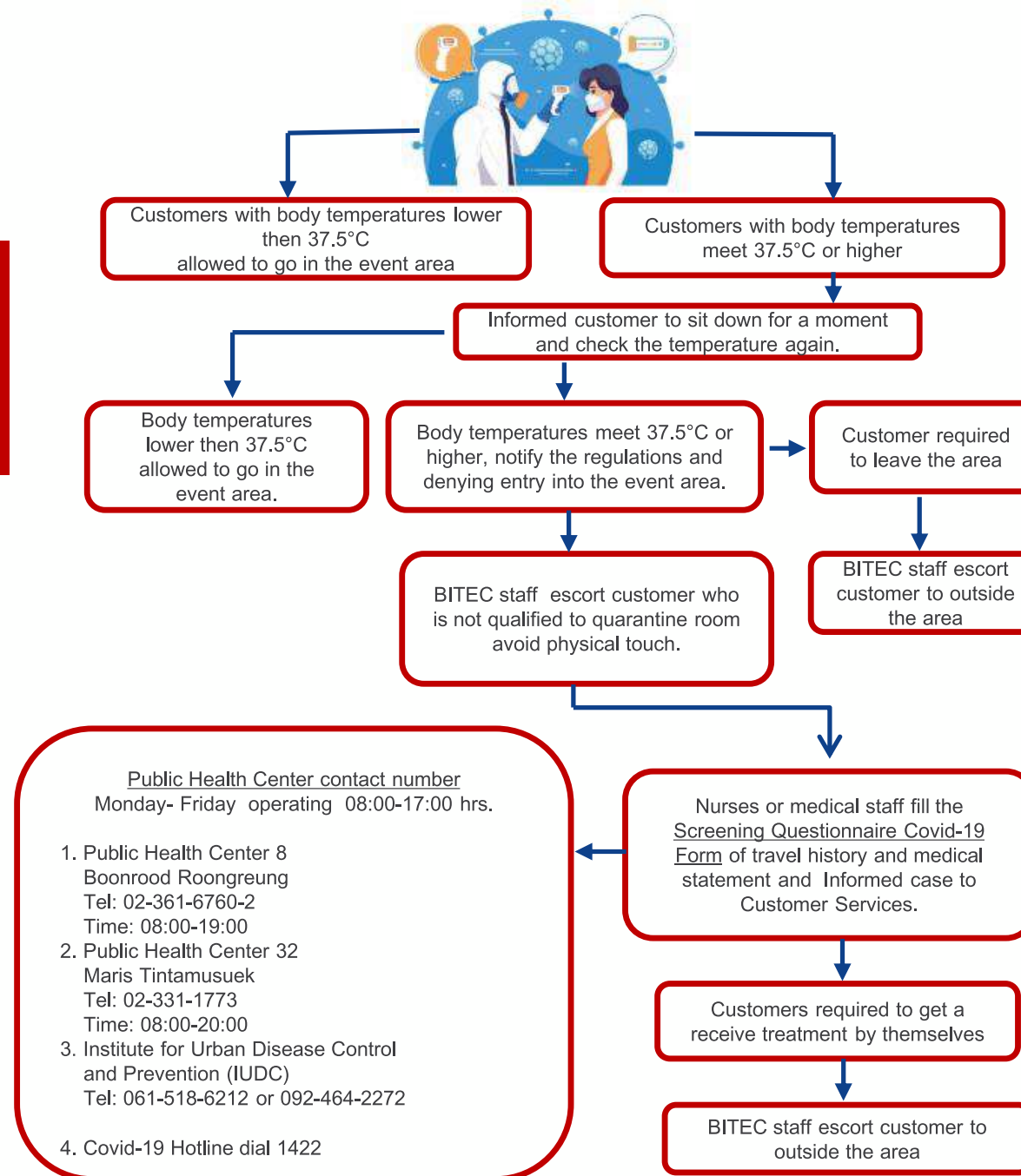

Screen & Check



Access & Crowd Control



- Limit entrances to the concourse and building
- Manage flow in – out
- Manage and limit number of attendee
 - 1 attendee per 4 sq.m.
 - Utilization of Floor Manager & CCTV
- Reserve available holding area by event

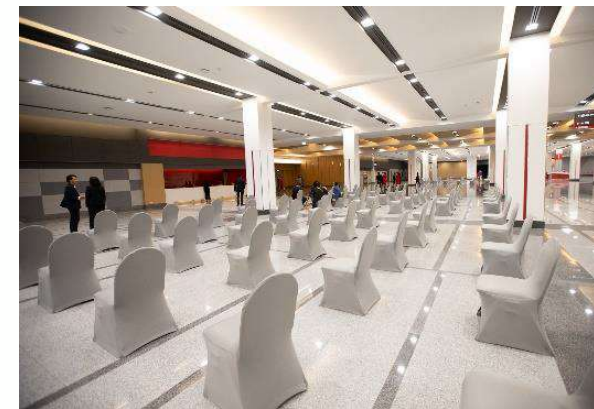

Full-House Scenario

- Thermal Scanner Camera
- Thermal Scanner Gun

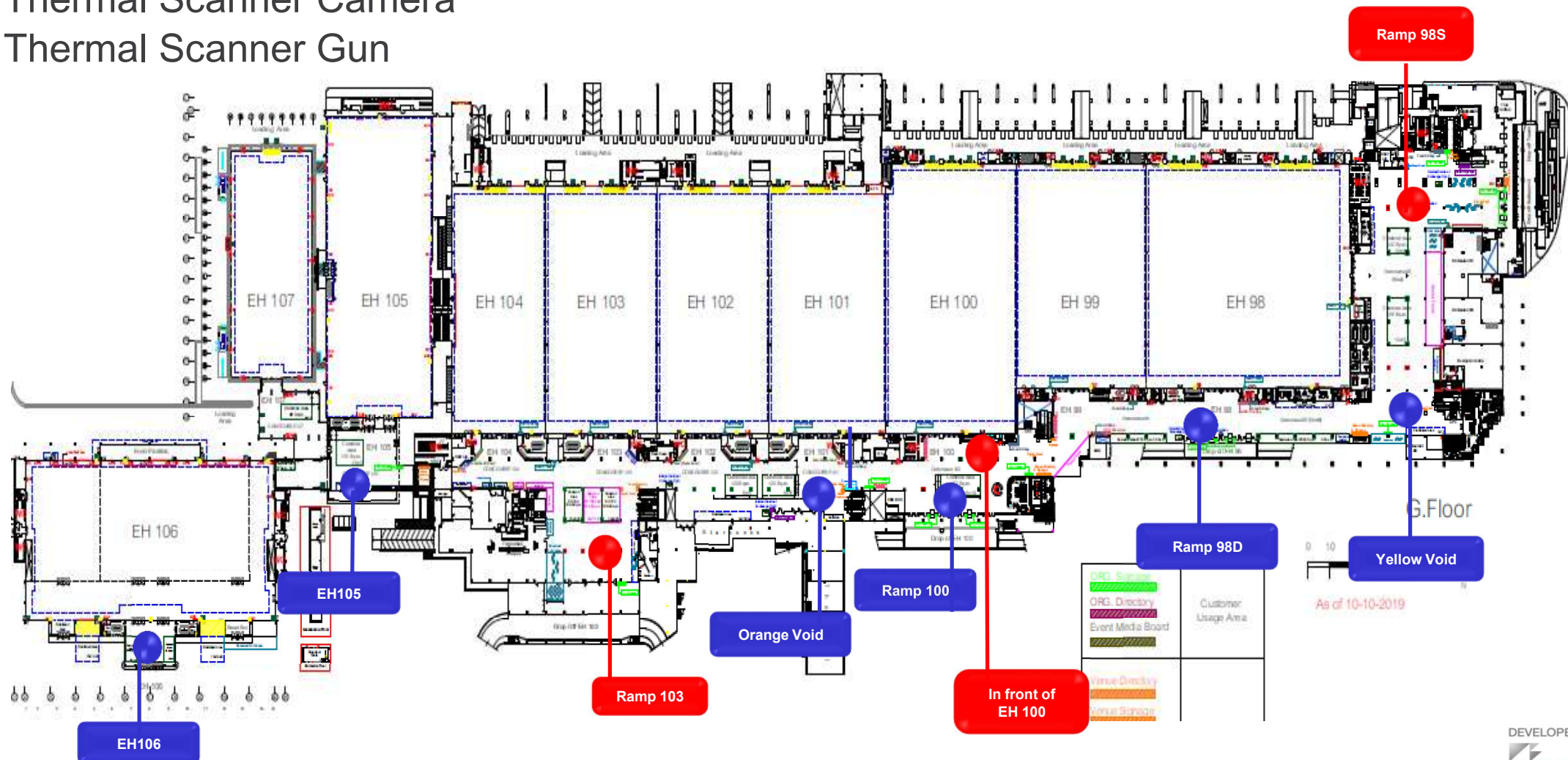

- Mark floor and signage to indicate space regulations for all queues and public space
 - At least 1 m. distance
 - 2 – 3 steps distance on escalators/ travellers

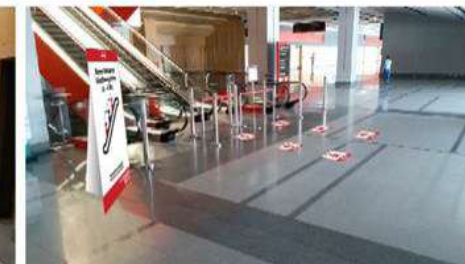

Service Space, Meeting

- Manage and limit number of attendee
- All seats are set-up by maintaining at least 1 m. distance between individuals



Physical Distancing

Service Space, Meeting with Banquet

- Pre-packed and individual set menu services
- At least 1 m. distance queue
- Serve and facilitate by touchless policy



Service Space, Exhibition

- Numbers of stakeholders with physical distancing, 4:1 of gangway/ accessible areas
- 50% up of floorplan managed for gangway/ accessible areas
- Safety/ Floor Managers assigned to monitor and enforce physical distancing



- Disinfectant spray in public area and service space
- Provide sanitizers at all key venue entrances
- Increase frequency of cleaning and sanitize public areas, restrooms, all venue's facilities and waste disposal



Safety & Hygiene



- Extra cleaners to sanitize touch points in public area i.e. lifts, escalators, doorknobs, etc.
- All parking cards sanitized before issuing to drivers
- Temporary close of Kids Zone and Pray Rooms
- Waste management for used masks



■ Sanitizing with recommended materials

22 MULTI-QUAT SANITIZER

Multi-Quat kills: (Bacteria)

Staphylococcus aureus (ATCC 6538)

Salmonella enterica (ATCC 10708)

Escherichia coli O157:H7 (ATCC 35150)

Listeria monocytogenes (ATCC 19117)

Multi-Quat is virucidal at 3:128 dilution (3 fl. oz. per 1 gallon of water) in the presence of 5% organic soil against:

- ✓ Herpes Simplex Type I Virus (ATCC VR-735)
- ✓ Avian Influenza Virus (VNH5N1-PR8)
- ✓ Canine Distemper Virus (ATCC VR-2006)
- ✓ Newcastle's Disease Virus (ATCC VR-109)



ชื่อและอัตราส่วนของสารสำคัญ

อัตราส่วนของสารสำคัญ	เปอร์เซ็นต์
อัลคิล(C14, 50%; C12, 40%; C16, 10%) ไดเมทิลเบนซิลแอมโมเนียมคลอไรด์	3.00%
ออกทิลเดซิลไดเมทิลแอมโมเนียมคลอไรด์	2.25%
ไดเดซิลไดเมทิลแอมโมเนียมคลอไรด์	1.35%
ไดออกทิลไดเมทิลแอมโมเนียมคลอไรด์	0.09%

ผลิตภัณฑ์ 22 Multi-Quat Sanitizer (หรืออีกชื่อทางการค้าหนึ่งว่า Oasis 146 Multi-Quat Sanitizer) มีชื่อและอัตราส่วนของสารสำคัญที่ใกล้เคียงกับผลิตภัณฑ์ที่ขึ้นทะเบียนใน List N กับ US EPA (US Environmental Protection Agency's) ซึ่งมีประสิทธิภาพในการต่อต้านเชื้อไวรัสที่คล้ายกันกับ 2019 Novel Coronavirus (SARS-CoV-2*) ดังนั้นสามารถพิจารณาได้ว่าผลิตภัณฑ์ 22 Multi-Quat Sanitizer และผลิตภัณฑ์ที่ขึ้นทะเบียนใน List N กับ US EPA มีประสิทธิภาพในการต่อต้านเชื้อไวรัสที่คล้ายกันกับ 2019 Novel Coronavirus (SARS-CoV-2*) ได้เช่นเดียวกัน

Elevated Measures & Innovation in place

- UVC light disinfection in AHU, air-conditioning units
- Extra cleaning and filters changing of air conditioning units
- Operate air ventilation of all areas before service-hours on daily basis

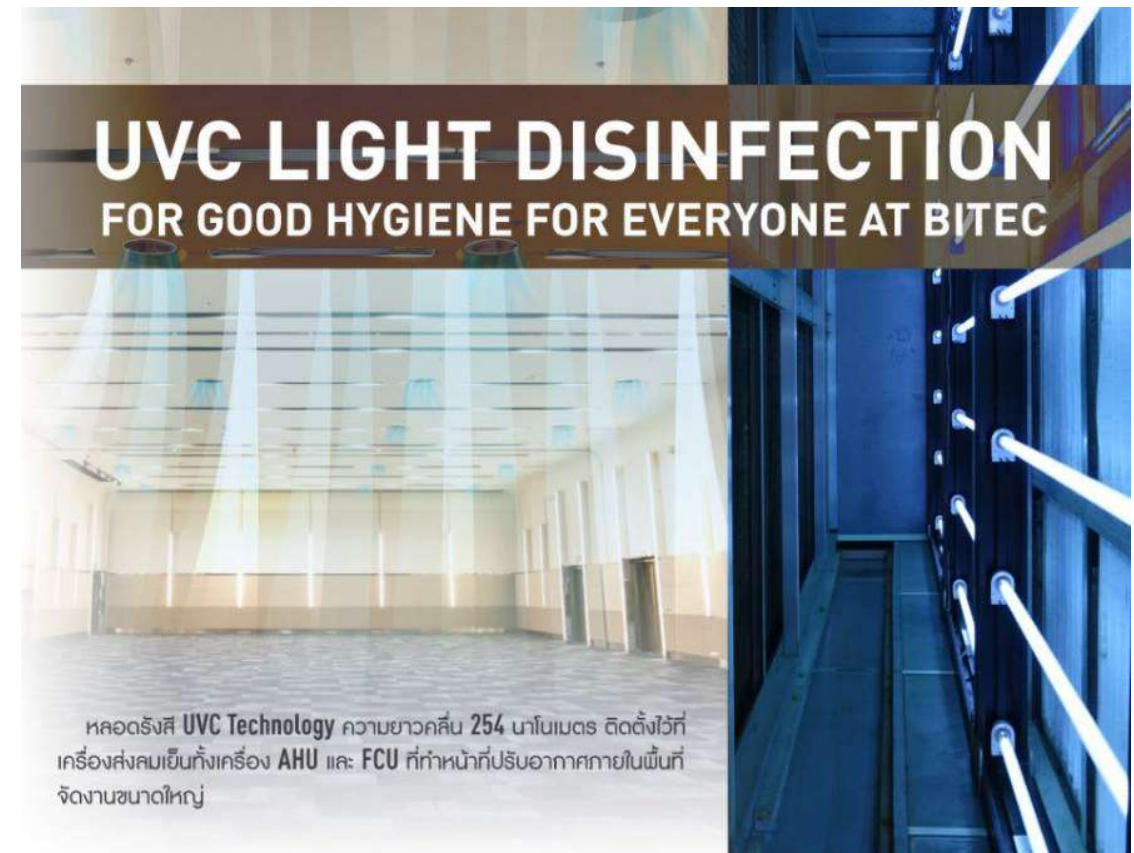

Elevated Measures for Service Space, Meeting

- Disinfectant spray in service space
- Increase frequency of cleaning and sanitize all meeting area, tables, chairs, AV equipment, etc. before and during event
- Provide sanitizers at meeting room entrance



Elevated Measures for Service Space, Exhibition

- Disinfectant spray in service space before hand-over, and daily on show-day*
- Increase frequency of cleaning and sanitize service space, touch points, surfaces, and waste disposal
- Provide sanitizers at all key entrances
- Upgrade sanitizer to 22 Multi-Quat for cleaning and sanitizing all area

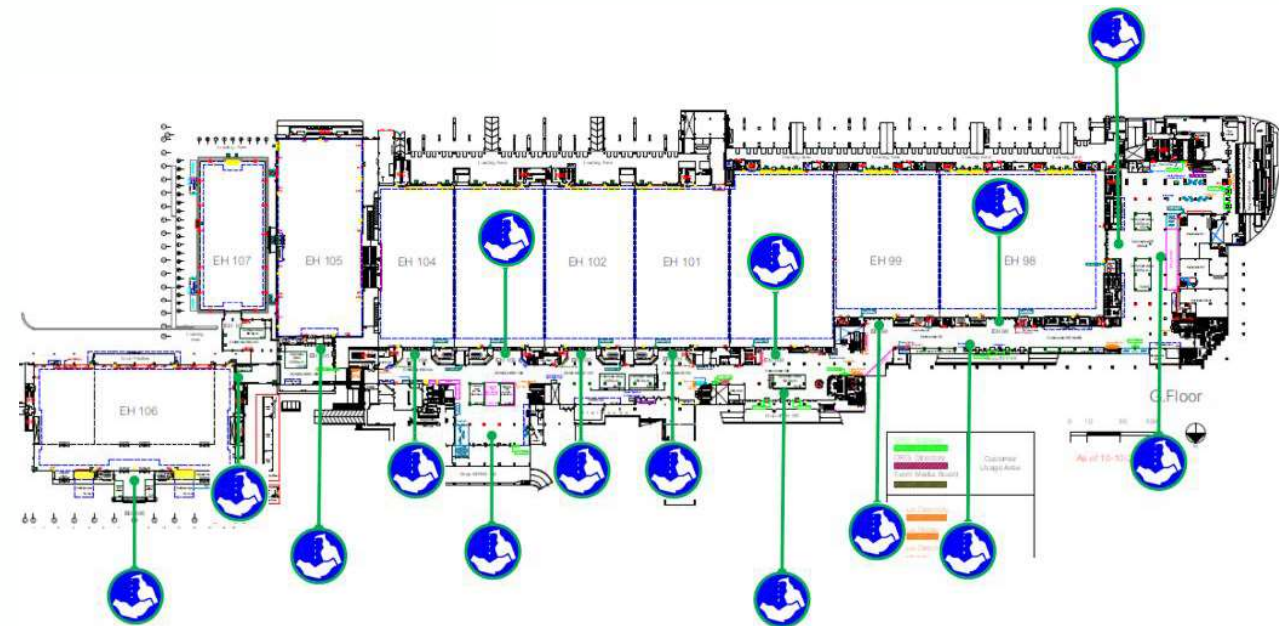

Extra Measures for Restaurant, Outlets and Retails

- Hot-cooking menu preferences
- Pre-packed and individual set menu options
- Sterilized food and beverage services equipment and packaging before service
- Disinfectant service area, tables & chairs after service

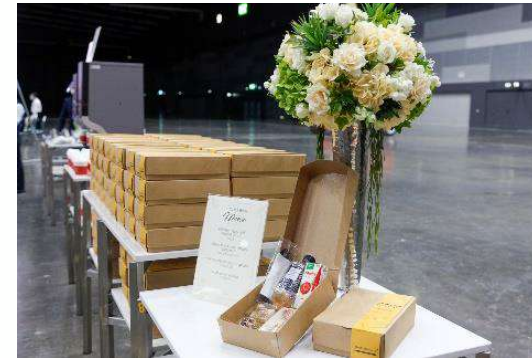

Extra Measures for Restaurant, Outlets and Retails

- Pre-booking & reservation
- E-payment option
- Counter-shield/ Table-shield



Extra Measures for Restaurant, Outlets and Retails

- Limit capacity

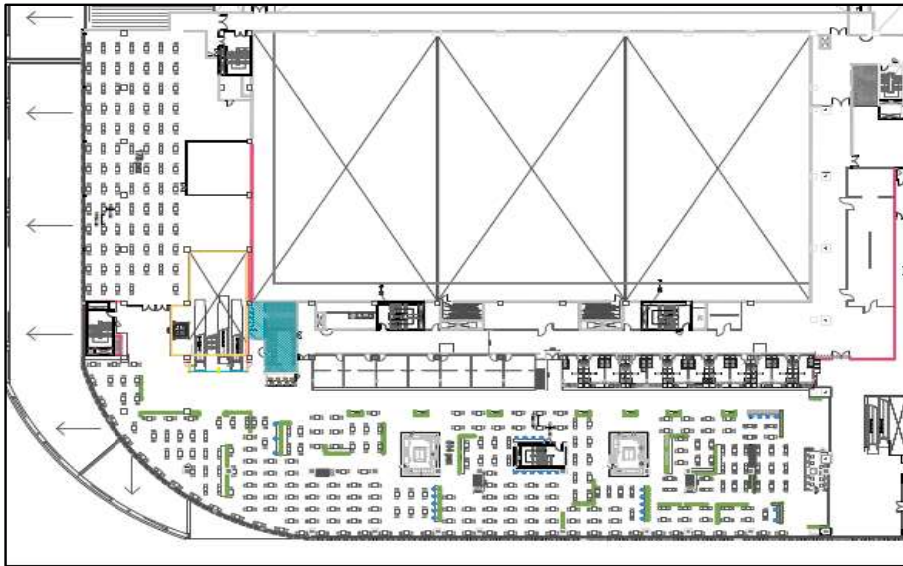

Food Yard 692 Seats

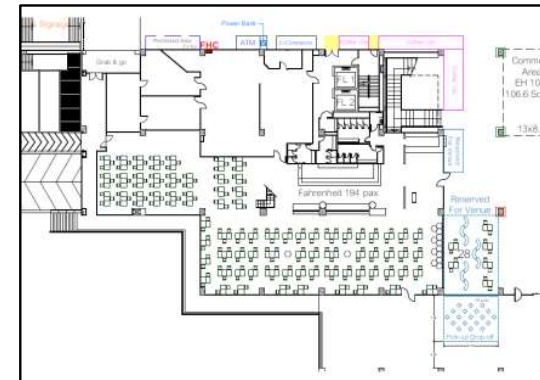

Fahrenheit 222 Seats

Extra Measures for Restaurant, Outlets and Retails

- Limit capacity

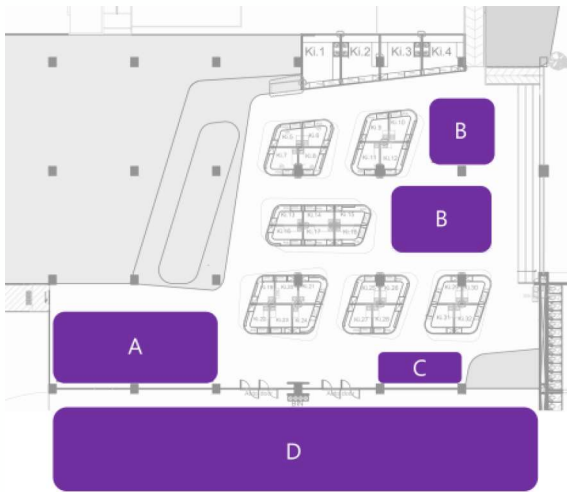

Kiosk Zone 200 Seats

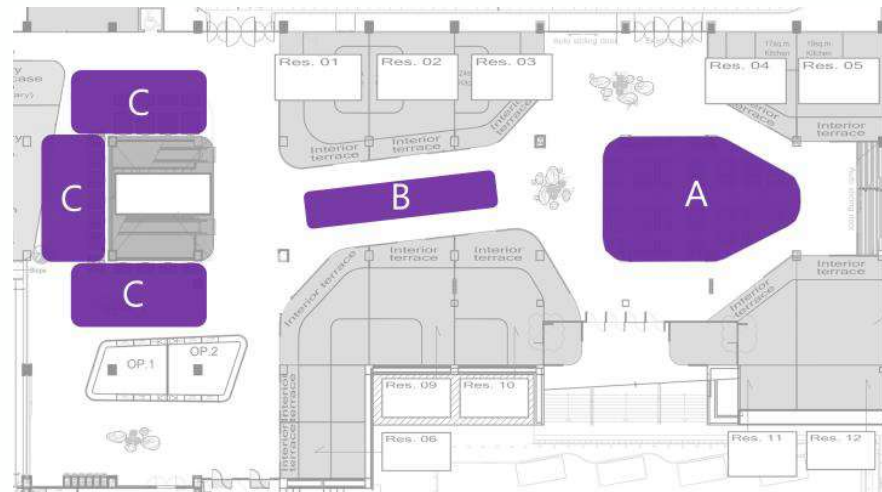

Dining Zone 150 Seats



Outlets 120 Seats

Personal & Personnel Safety

- All service staff, casual, and tenants are checked body temperatures
- All staff and personnel wear mask and appropriate prevention material
- Encourage hand-washing break
- Enable Touchless Policy
- Enable Cashless Policy



Encourage & Enforce



- Display and announce venue's health screening measures
- Publish venues' health & safety standard and measures for public awareness
- Provide knowledge and signage of safety guidelines, suggestion and measures with the Contact of Department of Disease Control Hotline 1422.
- Announcement to encourage safety and hygiene measures on paging system

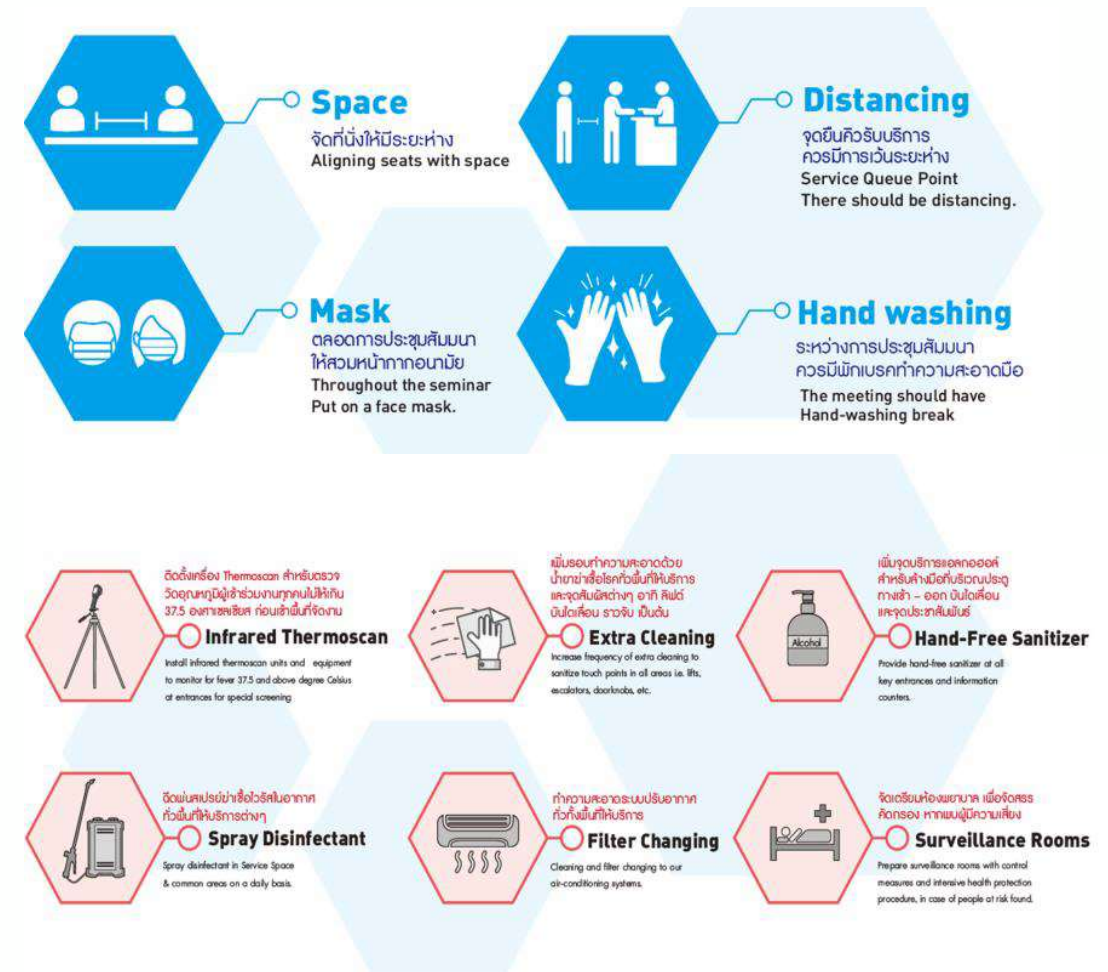

Encourage & Enforce



Measures Checklist for Venue -Organisers	Venue	Exhibition	Meeting	Special Event
Limit number of all stakeholders in areas, 1:4	✓ (public)	✓	✓	✓
Thai Chana check-in/out & Pre-registration	✓	✓	✓	✓
Thermal Scanner – temperature check	✓	✓ (extra)	✓ (extra)	✓ (extra)
Air ventilation & purifier devices	✓			
Surface cleaning and disinfection	✓	✓ (in hall)	✓	✓ (in hall)
Exhibits cleaning and disinfection		✓ (in hall)		
Hand sanitizers	✓	✓ (in hall)	✓ (extra)	✓ (in hall)
Personnel & personal safety manual	✓	✓	✓	✓
Physical distancing floor signage	✓	✓ (in hall)	✓ (in hall)	✓ (in hall)
Physical distancing floor/ seating plans	✓	✓ (in hall)	✓ (in hall)	✓ (in hall)
One-way direction and crowd circulation	✓	✓ (in hall)	✓ (in hall)	✓ (in hall)

Encourage & Enforce



Guidelines	Venue	Exhibition	Meeting	Special Event
Safety/ floor manager onsite and monitor	✓	✓ (in hall)	✓ (in hall)	✓ (in hall)
Contactless & Cashless Policies	✓	✓	✓	✓
Measures and information signage	✓	✓ (in hall)	✓ (in hall)	✓ (in hall)
Travel Recommendation	✓	✓	✓	✓
Limit attendees/ contractors/ stakeholders	✓	✓	✓	✓
Limit and adapt event programs/ formats		✓	✓	✓
Attendees data traceability (60 days after event)	✓	✓	✓	✓
Deny entry of suspected and who failed health screening and prevention materials	✓	✓	✓	✓
Isolate and facilitate suspected person to hospital	✓	✓	✓	✓

THANK YOU

FOR MORE INFORMATION, please contact Customer Services Department



BITEC B-Square



BITEC_Bsquare



BITEC_Bsquare